

# DC Bluetooth High Bay Sensor

## Plug & Play Type



EFS106-BH4



EFS106-AUX



EFS106-Z10

mating receptacle(not included in the product package)



BH4



SC01-AUX



Zhaga-Z10



SC03-AUX



## FEATURES

The Keilton EFS106 series are designed for Luminaire Level Lighting Control (LLLC/NLC5) with integrated daylight harvesting and PIR motion sensors. SC01-AUX provide the sensor port for EFS106-AUX, which is designed for pre-installation in linear high bay or UFO high bay luminaires. EFS106 is a low voltage high bay sensor equipped with the **AlgoH™** algorithm to maximize detection for high bay applications up to 40 ft without false triggers.

- Plug and Play with Sensor Port Pre-installed
- Bluetooth Network Technology
- Design for High Bay applications
- **AlgoH™** algorithm enhance performance in high bay applications
- Analog Sensor Built-in
- Replaceable lens options
- 12V DC input
- Daylight harvesting available

## SPECIFICATIONS

Input Voltage: DC 12V  
 Input Current: 50mA Max  
 Input Power: 0.6W  
 Output Voltage: DC 10V  
 Output Current: 10mA Max  
 Output Power: 0.1W  
 Dimming: Class 2, 0-10V DC 10mA Max  
 Sinking Current: 10mA Max

Bluetooth Transmit: 100ft Max  
 Radio Frequency: 2.4GHz ± 75MHz  
 Bluetooth Version: 4.2  
 Housing Material: UL 94-5VA,  
 Indoor / Outdoor Use  
 Detection Range: 40-80ft  
 Mounting Height: 20-40ft  
 Operating Temperature: -30°C to 55°C,  
 -22°F to 131°F  
 Storage Temperature: -30°C to 85°C,  
 -22°F to 185°F  
 IP Rating: IP66  
 Color: White,Black,Brown  
 Warranty: 5 years warranty

Comply to UL8750, UL1376, RoHS

Compliant Standard Interfaces:

Zhaga book 18

Safety: cULus Listed LED Controller

E504054

FCC ID: 2A26YLTkTVT2021

DID: D057145

DLC: NLTRC5KL0TN

MODEL	DESCRIPTION
EFS106-BH4	Fixture Integrated Network PIR&Daylight Harvesting Sensor- BH4 Base
EFS106-AUX	Fixture Integrated Network PIR&Daylight Harvesting Sensor- 3.5mm Audio Jack Base
EFS106-Z10	Fixture Integrated Network PIR&Daylight Harvesting Sensor - Zhaga Base

**WIRING**

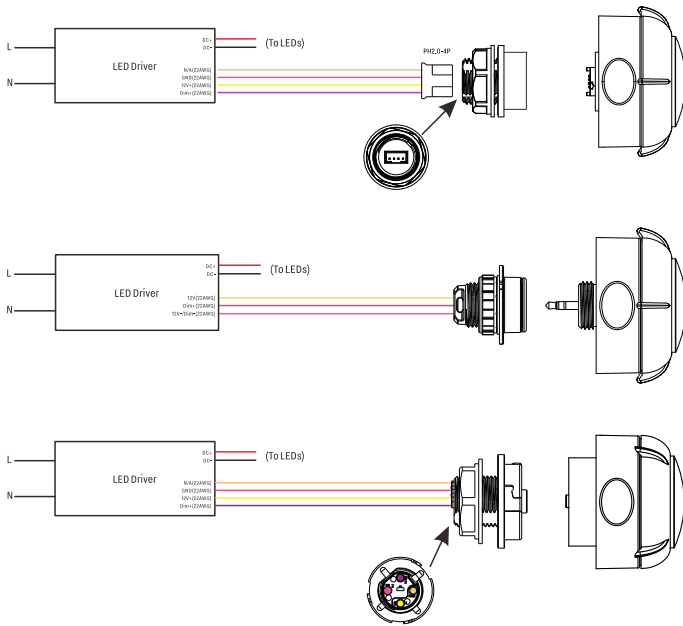

1/2 inch US standard knockout

AMERICAN INCH PRODUCTS		
Size	T.P.I	Major Dia.
R1/2	14	0.825

**DIMENSIONS**

Unit: inch/mm

**EFS106-BH4**

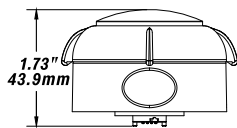

**EFS106-AUX**

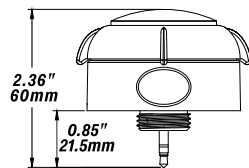

**EFS106-Z10**

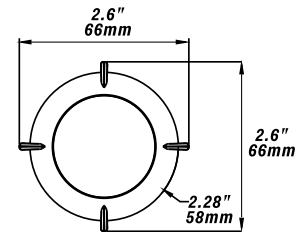
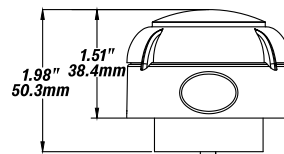

**BH4**

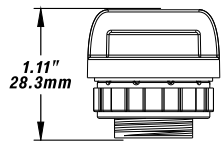

**SC01-AUX**

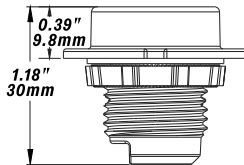

**Z10**

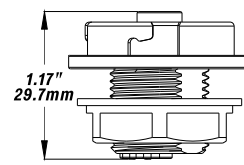

**SC03-AUX**

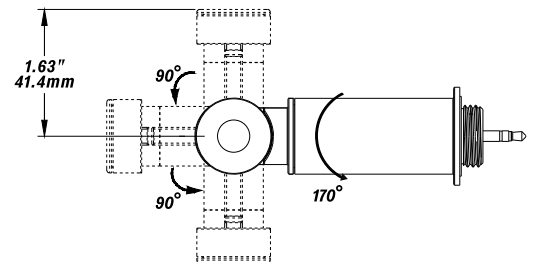
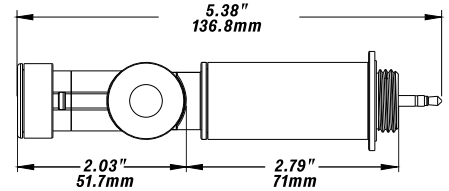

## DIMENSIONS

Unit: inch/mm

### HBL1

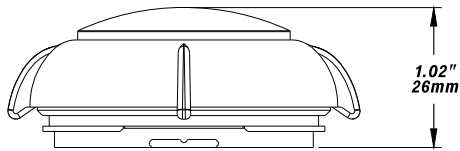

Coverage Side View

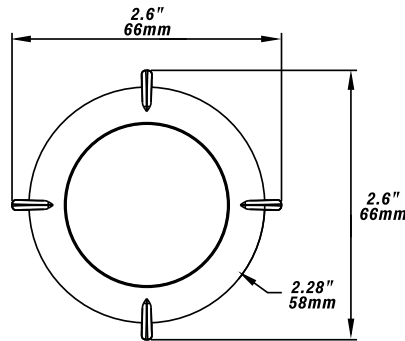

Coverage Top View

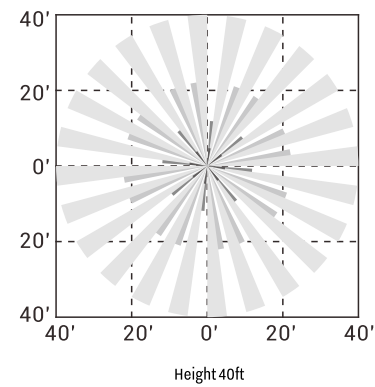
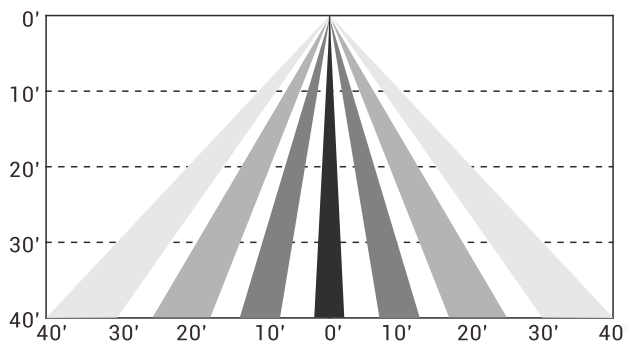

Height 40ft

## MARKING

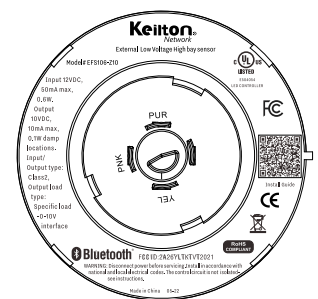
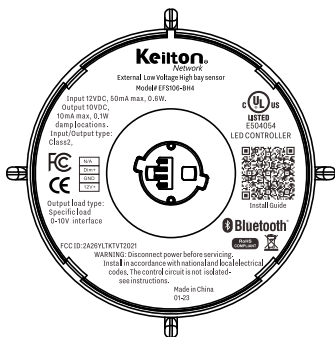

The Bluetooth word mark and logos are registered trademarks owned by Bluetooth SIG, Inc. and any use of such marks by Litetrace is under license. Other trademarks and trade names are those of their respective owners.

## APP DOWNLOAD

